

User's manual



POLMP01B
POLMP01W
POLMP01BL
POLMP01R



Power on/off

Press the power button for about 3 to 5 seconds.
Press the power button for about 2 seconds.

Note
When you turn on the power, the operating status LED indicator blinks for about 5 seconds. You can print it out when the blinking ends, and the LED is turned on white.

Charging the battery
This device has a built-in battery. Make sure that the battery is charged fully before use. Average charging time: About 1 hour and 30 minutes



Table with 2 columns: Charging status indicator, Description of status. Rows include Charging in progress and Charging completed.

Notice
Use the standard charger provided by this device.
The use of a non-standard charger can cause malfunction and exception from the subjects of warranty service.
There may be the risk of electric shock during the process of charging, so please use with care.
Do not give abnormal impacts.

Safety Precautions

This equipment has been tested and found to comply with the limits for a Class B digital device, pursuant to Part 15 of the FCC Rules. These limits are designed to provide reasonable protection against harmful interference in a residential installation.

If this equipment does cause harmful interference to radio or television reception which can be determined by turning the equipment off and on, the user is encouraged to try to correct the interference by one or more of the following measures.

- Reorient or relocate the receiving antenna.
Increase the separation between the equipment and receiver.
Connect the equipment into an outlet on a circuit different from that to which the receiver is connected.
Consult the dealer or an experienced radio, TV technical for help.

This device complies with Part 15 of the FCC Rules. Operation is subject to the following two conditions: (1) this device may not cause harmful interference, and (2) this device must accept any interference received, including interference that may cause undesired operation of this device.

CAUTION

Any changes or modifications in construction of this device which are not expressly approved by the party responsible for compliance could void the user's authority to operate the equipment.

CE WARNING
Changes and modifications not expressly approved by the party responsible for compliance could void the user's authority to operate the equipment.
It is desirable that it be installed and operated with at least 20cm or more between the radiator and person's body (excluding extremities: hand, wrist, feet, and ankles)

EN Test Regulations
ETSI EN 300 328 V1.8.1
ETSI EN 301 489-1 V1.9.2
ETSI EN 301 489-17 V2.2.1
EN 60950-1:2006(A1:2009(A1:2010(A1:2011(A1:2012:2011(A2:2013)

BATTERY WARNINGS
1 Avoid contact with leaking or a damaged battery.
2 Do not short battery terminals.
3 Adult supervision is recommended when product is used by young children.
4 Avoid areas of excessive heat or moisture.
5 Do not disassemble the battery.

STAND-BY
This product contains electrical or electronic materials. The presence of these materials may, if not disposed of properly, have potential adverse effects on the environment and human health. Presence of this label on the product means it should not be disposed of as unsorted waste and must be collected separately.

Safety Precautions

WARNING
A violation of labeling regulations can cause serious injury or death.

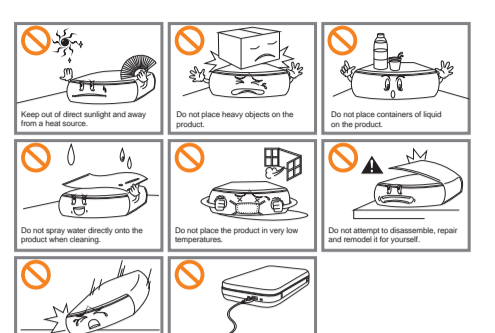

NOTICE
A violation of labeling regulations causes minor injury or damage to the product.



Operating Temperature

If the optimum operating temperature of (15~32°C) is not met when using this device, it may not print or lead to failure to provide the best print quality. For stability of the product, refrain from using it at a low temperature in the winter.

Table of Contents

1. Items confirmed before use 6
Components check
Names of parts
Power on/off
Charging the battery
2. Application installation 8
Installation in Store
3. Cover Open method 10
4. Inserting printing paper 10
5. Printing 12
Android OS
iOS
Settings
Print Mode
6. Checking LED indicators 20
7. Product specifications 21
8. Items to check before reporting a malfunction 22

1. Items confirmed before use

Components check

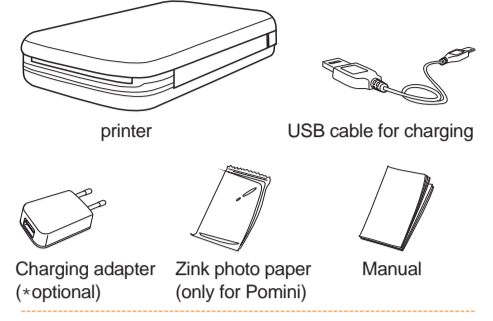

Names of parts

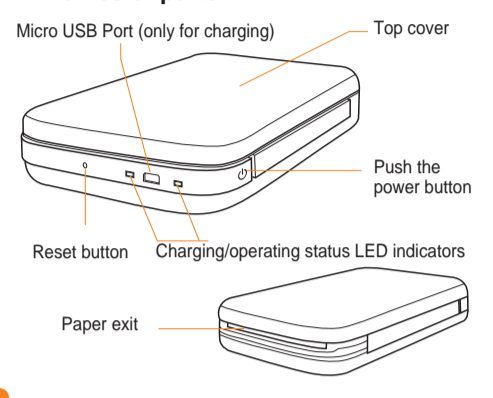

5. Printing

- 1. Execute a dedicated App after turning on the power of the printer.
2. Select the desired photo from [Take a Picture / Photo Album] after selecting [Print] from the App's main screen.
3. Select the Print button at the top right corner of the Edit screen.

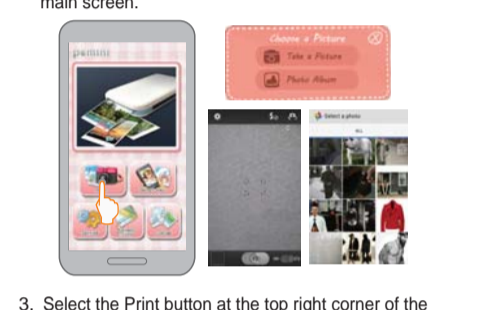

Notice
Optimum image quality cannot be guaranteed when the Smart Sheet of each printing paper pack is not used, or the bar code is damaged.
Long-term storage after opening the printing paper pack can have a bad effect on printing quality due to a discoloration or distortion of printing paper.

4. Begin searching for surrounding Pomiini when selecting "Search for devices" after selecting "Yes" on the Bluetooth permission request window.

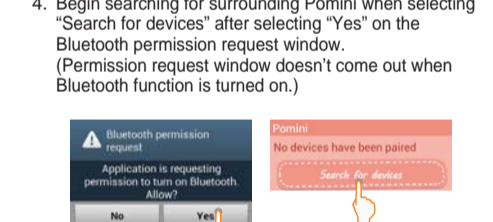

5. Select "Pomiini(XX-XX)" from the Other Available Device list and select "OK" when "Bluetooth pairing request" pops up. (MAC Address can be checked in the label inside the device.)

*Pairing request window may not come out depending on the Phone type.

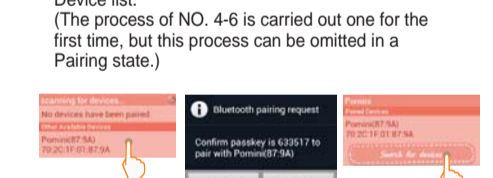

Print Mode

Image Full
As shown in the left side of the picture, the photo matches the printing paper so that the full image can appear in Image Full.



Paper Full
As shown in the left side of the picture, the photo matches the printing paper so that the image can be resized in Paper Full.

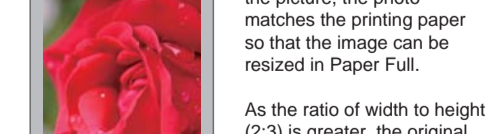

2. Application installation

Installation in Store

Android: Search for "Pomiini" in Play Store for installation.
iOS: Search for "Pomiini" in AppStore for installation.

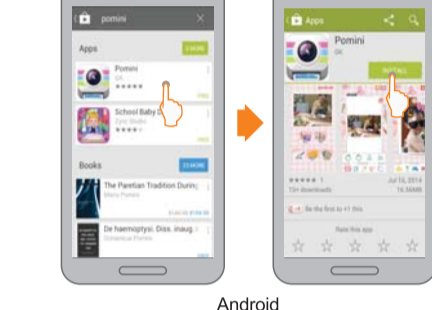

(* Android phone that supports NFC function is connected to Pomiini via NFC when it comes in contact with the top cover.)

IOS

Search for "Pomiini" in AppStore for installation.

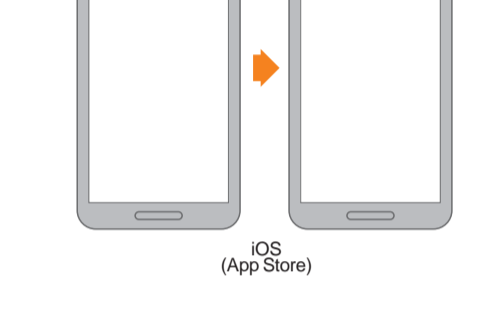

Installation with QR Code

Scan the QR Code in the product box and install the App.

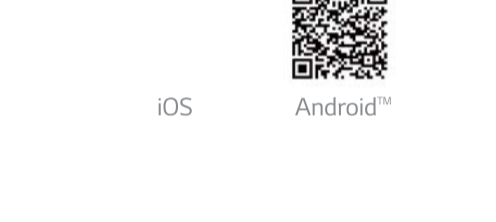

3. Cover Open method

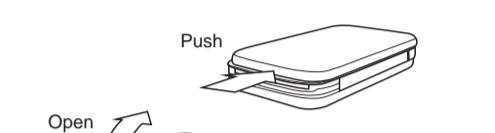

4. Inserting printing paper

- Prepare the blue Smart Sheet and white printing paper pack after unpacking the photo printing paper pack.
Open the top cover and insert the Smart Sheet and printing paper as shown in the figure.



Notice
Do not open the Cover while printing.
Printing quality of output cannot be guaranteed in case of using Zink paper of other companies.

Zink Smart Sheet



Features
Provide optimum image quality correction suitable for each printing paper pack.
Remove foreign objects from printer head.

How to use
Eject automatically before printing out the paper in initial output.
Poor quality and occurrence of horizontal lines can be improved by repeatedly printing 2 to 3 times.
Recycle until the printing paper of each printing paper pack is exhausted.

Notice
Optimum image quality cannot be guaranteed when the Smart Sheet of each printing paper pack is not used, or the bar code is damaged.

6. Description of LED Status Indicators



Table with 4 columns: Charging status indicator, Operating status indicator, Current status, Details. Rows include Standby On, Charging in progress, Charging is fully charged, Operating/Flashing, and Error/Flashing.

7. Product specifications

Table with 2 columns: Type, Size. Rows include Paper size (50 x 76 mm), Type of supported image file/size, Paper storage conditions, Product operating conditions, Optimal print conditions, LED display, Communication, External connection terminal, USB power supply, Built-in battery, Weight, Support App version.

8. Items to check before reporting a malfunction

Table with 2 columns: Problems, Checklist. Rows include Power does not turn on, Bluetooth connection is not established, Printing paper seems to be jammed, Stopped during printing operation, The power turns off automatically after a certain period of time, The printed photo shows a line, The printed photo shows a slash mark, The printed photo shows a slash mark.

Problems Checklist

Table with 2 columns: Problems, Checklist. Rows include White LED flashes and printed paper does not come out, Printed paper comes out too late, The printed image quality differs greatly from the original image quality, The above methods do not resolve the problems.

Warranty Card

Warranty Card form with fields for Name, Address, Phone no, Model no, Serial no, Date of purchase, and a description of the warranty terms.

PRINTING INFORMATION
COLOR: CMYK
PROCESS: Offset Printing
MATERIAL

Table with columns: DATE, NO, CONTENT, SIGN, and sub-columns A, B, C.

Table with columns: NO, CODE, MATERIAL, TREATMENT, QTY, MODEL, REMARK. Includes a signature line for 'MANUAL USER (Japan)' and 'GK07X0000100'.