

User Manual

Product Name: GRAVAT Smart Power Trainer

Model: T11,T11A,T11B,T11C,T11D,T11E,

T11F,T11G,T11H,T11J



Brand: MAGENE

Manufacture: Magene Technology Co., Ltd.

Quick Start Guide

Thank you for purchasing GRAVAT Smart Power Trainer. **Please do read this guide before**

use. Visit www.magene.cn for more information about GRAVAT Smart Power Trainer.

Feel free to contact us at:

- Email: service@magene.cn
- TEL: 4006628297
- QQ: 3337017453
- Web: www.magene.cn

CAUTION

- Keep children and pets away from GRAVAT Smart Power Trainer while in use.
- Only use GRAVAT Smart Power Trainer on a stable, level surface. Before beginning or modifying any exercise program, please consult your physician.
- Do not put hands or objects near moving parts of GRAVAT Smart Power Trainer.
- GRAVAT Smart Power Trainer may become too hot to touch when used for extended periods of time.
- Do not attempt to dismount the bicycle when the flywheel is in motion.
- Use caution when standing while riding on GRAVAT Smart Power Trainer.
- Keep GRAVAT Smart Power Trainer away from water and fire.

CAUTION

GRAVAT Smart Power Trainer's built-in power meter cannot tolerate fierce vibration. As showing in the picture, use a zip tie to tighten the bolt to the frame of GRAVAT Smart Power Trainer during the transportation. **Please remove the zip tie before using GRAVAT Smart Power Trainer, or else the built-in power meter won't work correctly.**

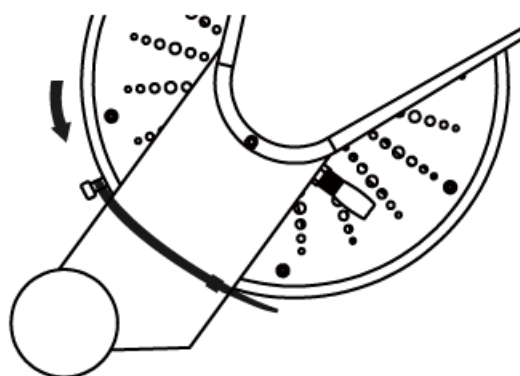

Unpacking

In the box you will find your (1) GRAVAT Smart Power Trainer, (2) AC adapter, (3) quick release skewer, (4) reversible axle spacer, and (5) ANT+ dongle. Remove your GRAVAT Smart Power Trainer Power Trainer and accessories from the box. Be sure to save the protective packaging for transportation and storage.

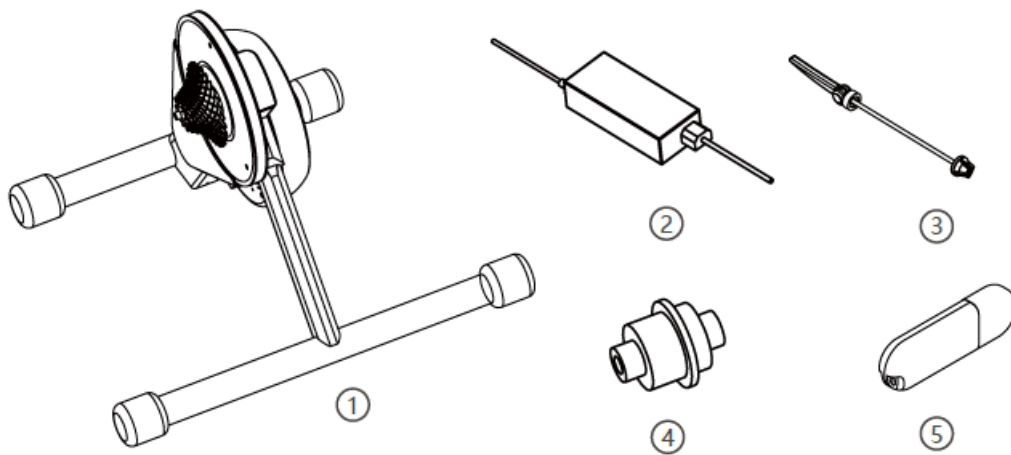

SETUP

1. Place your GRAVAT Smart Power Trainer power trainer on a stable, level surface and ensure there is no dangerous objects around.
2. Pivot the leg outward until it doesn't wobble.
3. Use the included AC power adapter to connect the trainer to a standard 100v~240v wall outlet.

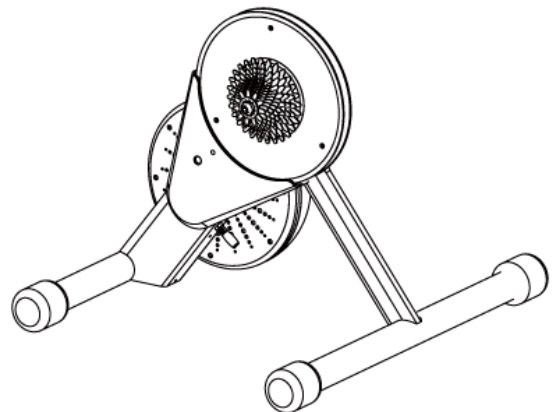
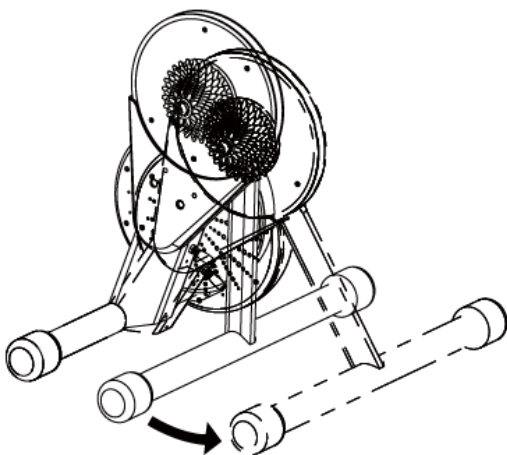

The reversible axle spacer can be used to accommodate 130mm or 135mm spacing. A cyclocross or mountain bike typically uses 135mm spacing. A typical road bike uses 130mm spacing. Please ensure the spacer accommodate your bike. Next, install the quick release skewer; leave the skewer loose to allow for easy bicycle installation.

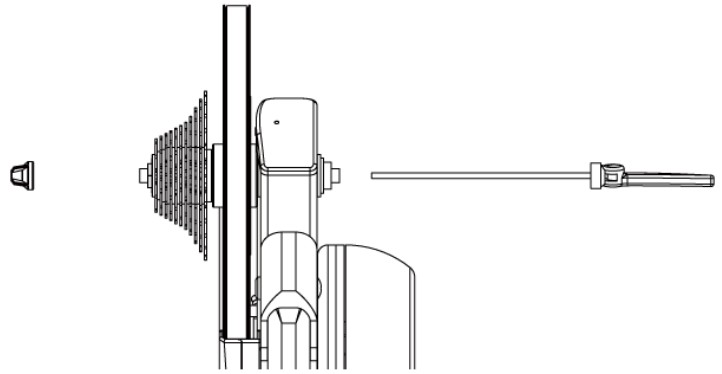
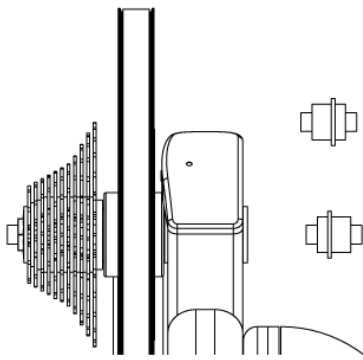

Attaching Your Bicycle

1. Shift your bicycle chain to the smallest sprocket in the front and rear, then remove the rear wheel.
2. Install your bicycle on the GRAVAT Smart Power Trainer by aligning the chain with the smallest sprocket on the GRAVAT Smart Power Trainer and pressing down to fully seat the dropouts on the GRAVAT Smart Power Trainer's axle.
3. Secure your bicycle by tightening the quick release acorn nut and clamping the quick release lever shut.
4. CAUTION! Failure to properly tighten the quick release may result in property damage or personal injury. If you are unsure of the proper tension please consult your local bike shop or contact Magene Tech for assistance. Do NOT ride the GRAVAT Smart Power Trainer until the quick release skewer is tightened.

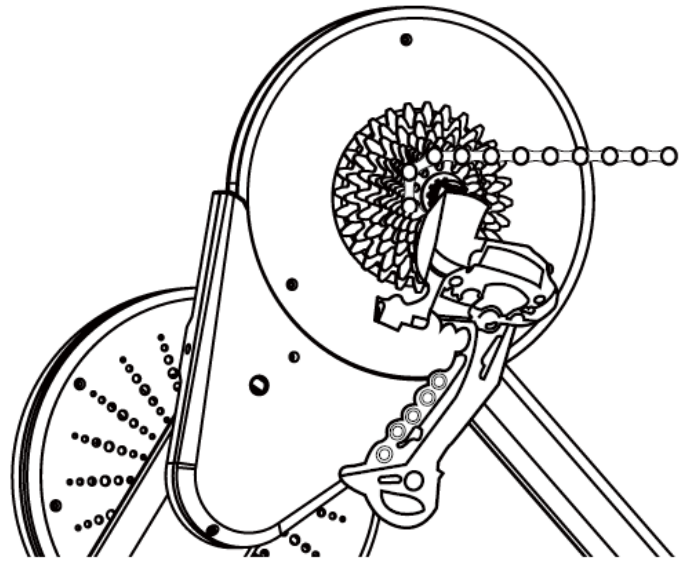

Connecting to the GRAVAT Smart Power Trainer

Once the AC power adapter is connected, the LED at the top of the frame will blink red twice to green. Then you will find ANT+ FE-C/Smart Trainer or Power Meter by searching through Onelap, Zwift or other training software, as well as Bike Computers.

- Visit www.onelap.cn to download Onelap(A free virtual riding software).
- To connect to the GRAVAT Smart Power Trainer, you need to plug in the included ANT+ dongle into your PC.

- If your training software or Bike Computers doesn't support smart trainer, you can search GRAVAT Smart Power Trainer's built-in power meter to use it.

Calibration

Please visit www.magene.cn to download GRAVAT Smart Power Trainer CALIBRATION TOOLBOX and do calibration according to the instructions.

Zero-Calibration

Please do a Zero-Calibration before first use and after transportation to improve accuracy.

Spindown-Calibration

The recommended calibration period is 4 weeks, which should be shortened if in heavy use. To get the most accurate data, warm-up 5 to 10 minutes before performing a Spindown-Calibration.

Indicator

GRAVAT Smart Power Trainer Status	Indicator
Power On	Blink red twice
Standby	Green
Working	Blink green
High Temperature	Blink red and green alternately
Error	Blink red

FCC Caution.

This device complies with part 15 of the FCC Rules. Operation is subject to the following two conditions: (1) This device may not cause harmful interference, and (2) this device must accept any interference received, including interference that may cause undesired operation.

Any Changes or modifications not expressly approved by the party responsible for compliance could void the user's authority to operate the equipment.

Note: This equipment has been tested and found to comply with the limits for a Class B digital device, pursuant to part 15 of the FCC Rules. These limits are designed to provide reasonable protection against harmful interference in a residential installation. This equipment generates uses and can radiate radio frequency energy and, if not installed and used in accordance with the instructions, may cause harmful interference to radio communications. However, there is no guarantee that interference will not occur in a particular installation. If this equipment does cause harmful interference to radio or television reception, which can be determined by turning the equipment off and on, the user is encouraged to try to correct the interference by one or more of the following measures:

- Reorient or relocate the receiving antenna.
- Increase the separation between the equipment and receiver.
- Connect the equipment into an outlet on a circuit different from that to which the receiver is connected.
- Consult the dealer or an experienced radio/TV technician for help.

The device has been evaluated to meet general RF exposure requirement. The device can be used in portable exposure condition without restriction.