

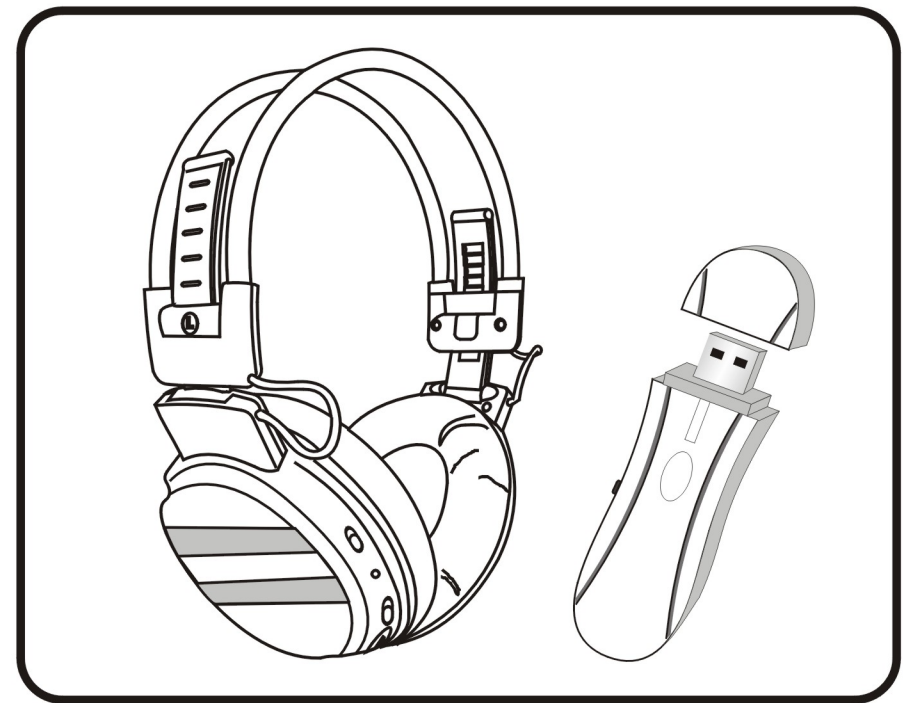

**HIGH FREQUENCY MODULATION**

# **WIRELESS STEREO HEADPHONE**



**RFS-688D**

## INSTALLATION BOOKLET

Before operating the system, please read this manual thoroughly and retain it for future reference.

## OVERVIEW

The **DIGITAL WIRELESS STEREO HEADPHONE SYSTEM** utilizes the latest wireless technology enable you to enjoy audio anywhere around your computer. You can simply connect the supplied transmitter to any usb port available. You can wear the Headphone and listen to quality audio without disturbing others.

## FEATURES

1. This system uses 2.4Ghz radio frequency wave giving you the freedom to move around surrounding area.
2. The headphone receiver can receive signals up to 20 meters away from transmitter, omnidirectional 360°
3. You can listen to your favorite music anywhere and anytime with out disturbing others
4. Fine tune allows you to adjust the tuner for the best possible transmission signal
5. Any number of additional wireless headphones can be added to the system using a single transmitter
6. Headphone has a power on/off switch with L.E.D. Indicator

## HOW TO USE

1. Turn on the computer.

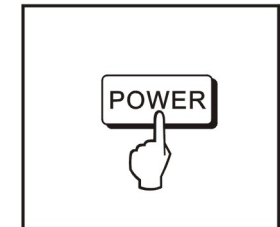

2. Plug USB digital into any open USB port.

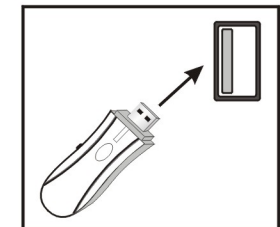

3. Turn on the power switch for headphone.

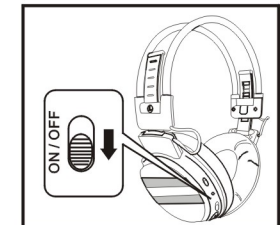

4. Adjust volume control on the left side. Do not cover the sensors while adjusting volumes.

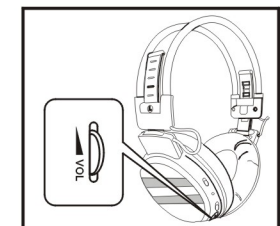

5. Receiving Positions  
The headphone/Receiver receives audio signals omni-directionally and in line-of-sight within certain effective ranges.  
For best reception, use the headphone.  
within 5 meters from the emitter of the transmitter.

## SPECIFICATIONS

### RFS-D688

RFS-D6800 (Digital)  
Technical Specifications  
Audio transmission method: Digital  
Transmitter frequency: 2.4GHz  
Signal-to-Noise ratio: 90 dB  
Dynamic range: 92 dB  
Channel separation: 88 dB  
THD: 0.1%  
Power Requirement DC 3V[1.5V(AAA)X2]  
Channel number: 8  
Input impedance: >10K Ohm  
Transmitter operating range: max. 20m line of sight.  
Frequency response: 16Hz ~ 24Khz.  
Output impedance: < 1K Ohm  
Maximum sound pressure level: 115 dB.

Notice: The changes or modifications not expressly approved by the party responsible for compliance could void the user's authority to operate the equipment.

IMPORTANT NOTE: To comply with the FCC RF exposure compliance requirements, no change to the antenna or the device is permitted. Any change to the antenna or the device could result in the device exceeding the RF exposure requirements and void user's authority to operate the device.

### FCC INFORMATION

The Federal Communication Commission Radio Frequency Interference Statement includes the following paragraph:

The equipment has been tested and found to comply with the limits for a Class B Digital Device, pursuant to part 15 of the FCC Rules. These limits are designed to provide reasonable protection against harmful interference in a residential installation. This equipment generates, uses and can radiate radio frequency energy and, if not installed and used in accordance with the instruction, may cause harmful interference to radio communication. However, there is no grantee that interference will not occur in a particular installation. If this equipment does cause harmful interference to radio or television reception, which can be determined by turning the equipment off and on, the user is encouraged to try to correct the interference by one or more of the following measures:

- Reorient or relocate the receiving antenna.
- Increase the separation between the equipment and receiver.
- Connect the equipment into an outlet on a circuit different from that to which the receiver is connected.
- Consult the dealer or an experienced radio/TV technician for help.

The user should not modify or change this equipment without written approval from Bright Headphone Electronics Co. Modification could void authority to use this equipment. This device complies with part 15 of the FCC Rules. Operation is subject to the following two conditions:

1. This device may not cause harmful interference.
2. This device must accept any interference received, including interference that may cause undesired operation.

## PRECAUTIONS

1. Operate the transmitter on Power From PC.
2. Do not open the transmitter case. Warranty can be void.
3. Do not leave the system in a location near heat sources such as airducts or dash boards.
4. Do not leave the system in a location subject to direct sunlight, excessive dust, Moisture, rain, extreme mechanical vibration or shock.
5. Do not use alcohol, benzene or thinner to clean the headphones.

### TROUBLESHOOTING GUIDE

SYMPTOM	CAUSE	SOLUTION
NO SOUND	The connected audio/video equipment is not playing.	Start playing the equipment.
	Audio/video equipment volume is completely turned down.	Adjust the volume to an appropriate level.
	The headphone batteries are low/dead.	Replace the batteries.
	The headphone is not turned on.	Turn on the power switch.
HISSING NOISES	The headphone volume is turned down.	Adjust the volume to an appropriate level.
	Frequency of receiver is not properly positioned	Adjust the fine tuning dial.
	The headphone is too far from transmitter.	Move closer to transmitter.
DISTORTED SOUND	There is a high pitch noise from T.V.	Contact our technician for optional noise suppressor.
	The input level of the audio signal is too low.	Turn up the volume of the equipment.
	The audio source is noisy	Check the source.
	The headphone batteries are low/dead.	Replace the batteries.
	The input level of the audio signal is too high	Turn down the volume of the equipment.