

OPERATION MANUAL

This pack contains Doorbell, Push Button, screws set and 12v A23 battery. (Supplied battery is for the purpose of testing; ALKALINE batteries are recommend for the best results.) Requires 2 "C" size batteries, a small flathead screwdriver and a crossed screwdriver.

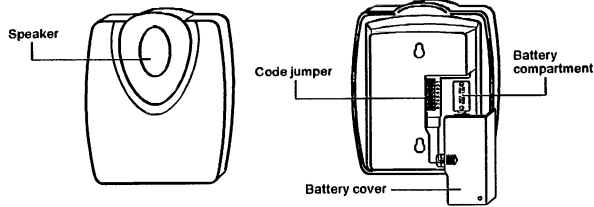

Push Button

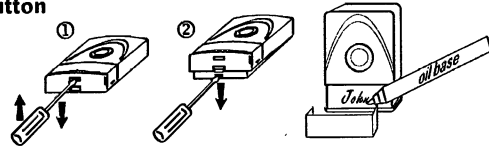

CODE SETTING

It is NOT necessary to change the setting unless interference occurs. If you need to reset code:

- Change the combination of the coding by inserting and/or removing the Jumper (numbered 1 to 8) inside of the battery compartment of both Doorbell and Push Button. (8 Jumper-caps packed in screws set pack for more combinations)

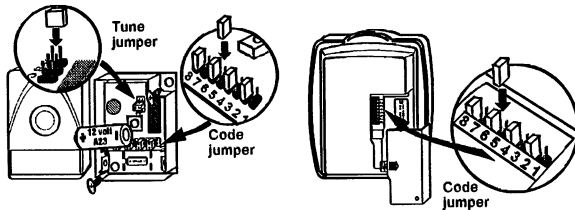

Don't forget that every time you change the code in the doorbell, the matching code must be changed in the Push Button.

TUNE SETTING

This feature provides the ability Different tunes to different Push Button. The Tune Jumper in the Push Button is factory pre-set to numbered "A". To change the playing tune by removing the Jumper cap then insert to "B" or "C".

Save and store the removed JUMPERS for future setting.

SPECIAL INFORMATION

- Positioning the Push Button and the Doorbell on or near metal structures or reinforced PVC μ doors or doorframes.
- Heat or moisture could adversely affect its performance in transmission range.
- Recommend checking and replacing batteries

BATTERY:

Usage of battery is up to one year (Push Button) and six months (Doorbell)**
 **Battery life varies with frequency of use and the type of battery used. This data is based on five times a day with TOSHIBA alkaline batteries.

WARNING

The user is cautioned that changes and modifications made to the equipment without the approval of manufacturer could void the user's authority to operate this equipment. The manufacturer is not responsible for any radio or TV interference caused by unauthorized modifications to this equipment.

TROUBLE SHOOTING

Problem	Possible cause	Solution
Doorbell not sounding	Batteries may not be inserted correctly	Check all batteries have been inserted correctly
	Doorbell may be positioned out of range of the Push Button	Move your Doorbell close to the Push Button
	A metallic object may be blocking the signal from the Push Button	Experiment with the location or orientation of your Doorbell to see if you can position it in a more suitable place
	The battery in the Push Button may need replacing	Replace the Push Button battery
False activation of the Doorbell	Your Push Button and Doorbell may have different code setting	Check the code setting in both your Doorbell and Push Button
	Another of your own or a neighbour's wireless product may be using the same code	Change the code setting in both your Push Button and Doorbell