

USER MANUAL

Jamo[®]

D I G I T A L D S 4





CONTENTS

CONTENU • CONTENIDO • INHALT • CONTENUTO • CONTEÚDO • 目录

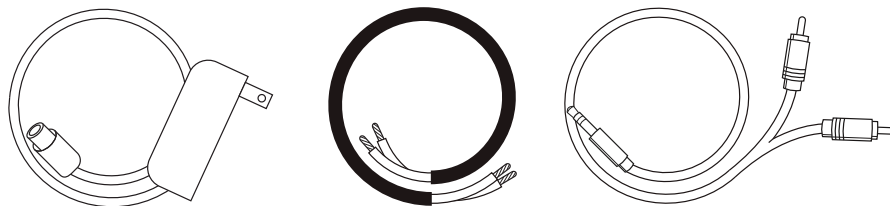
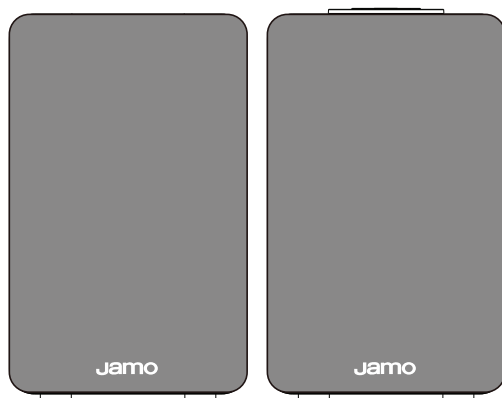

SETUP

INSTALLATION • CONFIGURACIÓN • SETUP • INSTALLAZIONE • INSTALAÇÃO • 设置

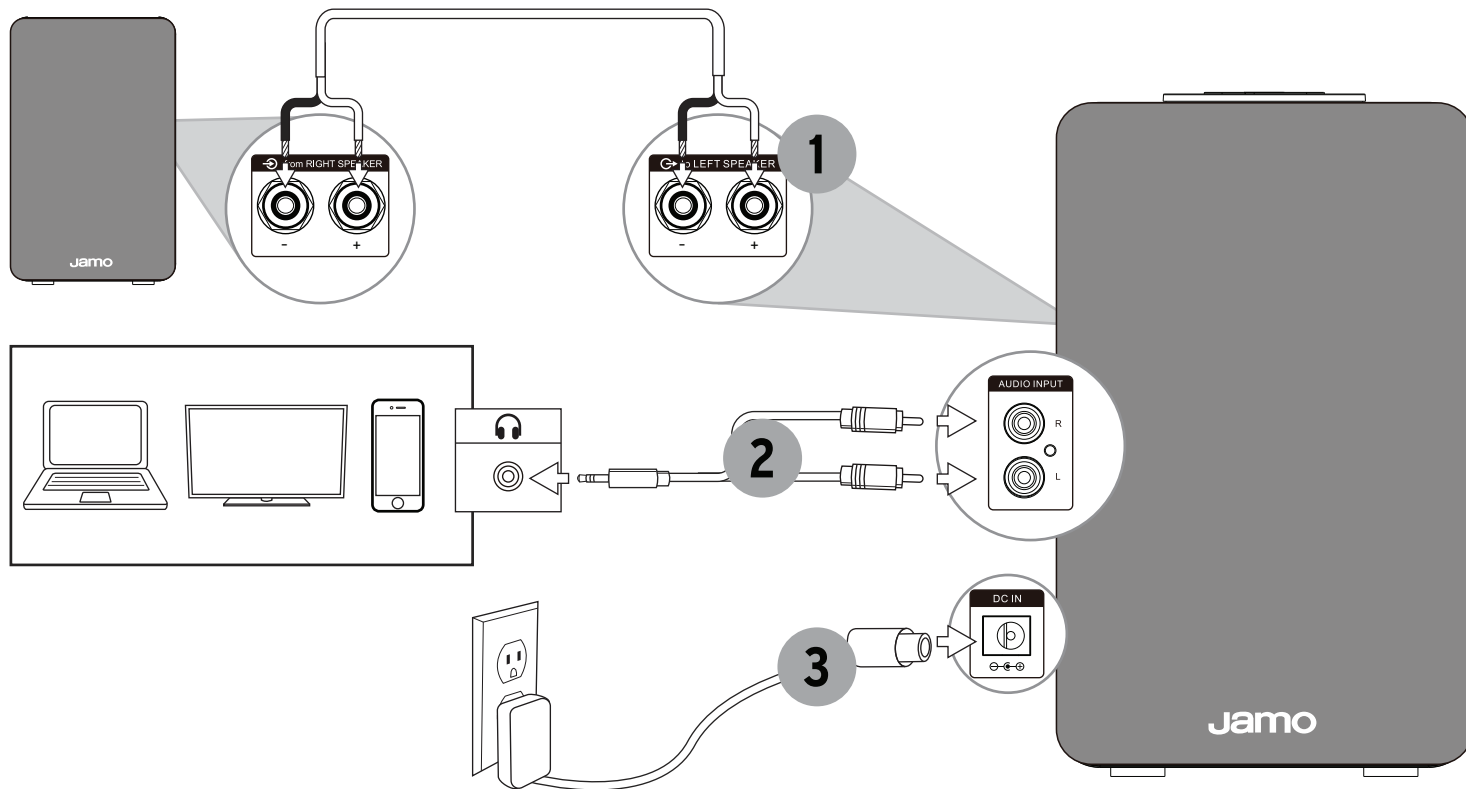

BLUETOOTH® WIRELESS TECHNOLOGY

TECNOLOGÍA INALÁMBRICA *BLUETOOTH*® • CONFIGURACIÓN DE TECNOLOGIA WIRELESS *BLUETOOTH*® • DRAHTLOSE *BLUETOOTH*®-TECHNOLOGIE-SETUP • CONFIGURAZIONE TECNOLOGIA WIRELESS *BLUETOOTH*® • CONFIGURAÇÃO DE TECNOLOGIA SEM FIO *BLUETOOTH*® • *BLUETOOTH*® 蓝牙无线电技术

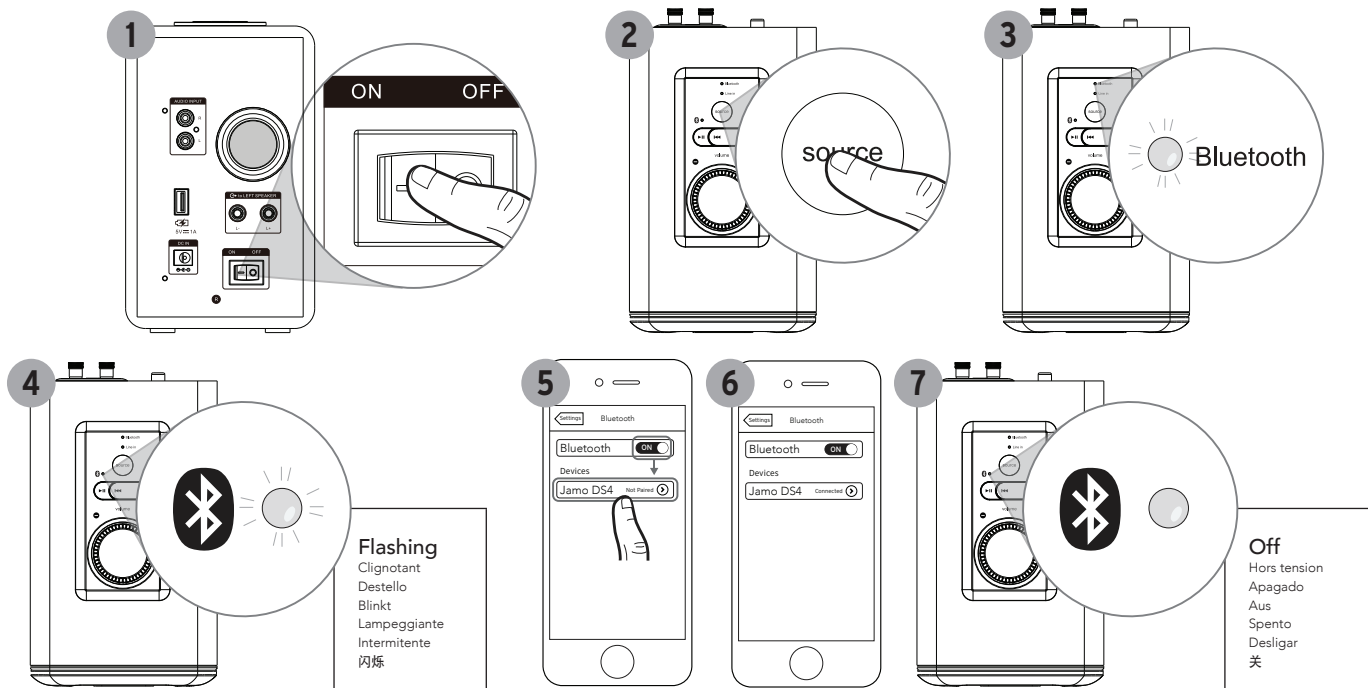

Example only. Your device may differ.

- À titre d'exemple seulement. Votre appareil peut être différent.
- Este es solo un ejemplo. Es posible que su dispositivo sea diferente.
- Nur als Beispiel. Ihr Gerät kann anders aussehen
- Solo a titolo esemplificativo. Lo specifico dispositivo può essere diverso.
- Apenas para exemplo. O dispositivo pode ser diferente.
- 仅为示例。实际设备可能有所不同

CHARGE DEVICES

CHARGEMENT DES APPAREILS • CARGA DE DISPOSITIVOS • GERÄTE AUFLADEN • CARREGUE DISPOSITIVOS • CARICA DI DISPOSITIVI • 充电设备

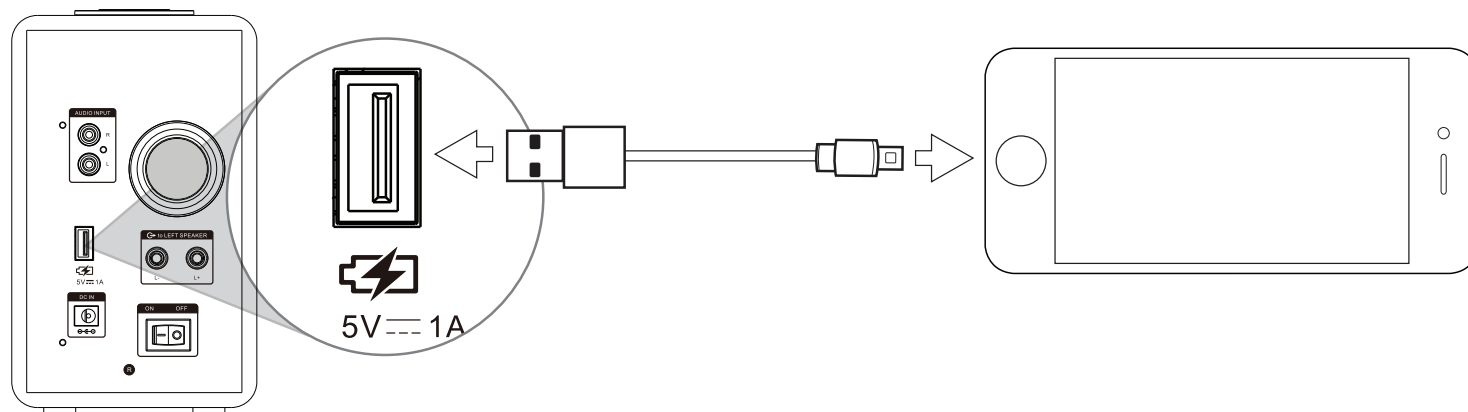

For more in-depth information and troubleshooting instructions visit [JAMO.COM/digital](https://www.jamo.com/digital)

Pour plus d'informations et des instructions de dépannage détaillées, consultez [JAMO.COM/digital](https://www.jamo.com/digital)

Hay información más detallada e instrucciones de detección y reparación de averías en [JAMO.COM/digital](https://www.jamo.com/digital)

Detalliertere Anweisungen und Hinweise zur Problembhebung finden Sie unter [JAMO.COM/digital](https://www.jamo.com/digital)

Per informazioni più dettagliate e istruzioni per la soluzione dei problemi, visitare [JAMO.COM/digital](https://www.jamo.com/digital)

Para obter informações mais detalhadas e instruções para solucionar problemas, visite o site [JAMO.COM/digital](https://www.jamo.com/digital)

欲了解更详细的信息和故障排除说明，请访问 [JAMO.COM/digital](https://www.jamo.com/digital)。

Jamo®

©2016 KLIPSCH GROUP, INC. JAMO IS A TRADEMARK OF KLIPSCH GROUP, INC., REGISTERED IN THE US AND OTHER COUNTRIES.

THE BLUETOOTH® WORD MARK IS A REGISTERED TRADEMARK OWNED BY BLUETOOTH SIG, INC. AND ANY USE OF SUCH MARK BY KLIPSCH GROUP, INC. IS UNDER LICENSE

