

Equalizer Setup

Equalizer Setup

1. Press and hold [] on the notification bar, or turn on [MENU - Settings - Equalizer].

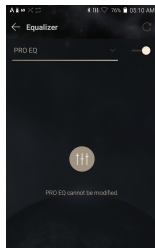

2. Press [Pro EQ] and select [+].

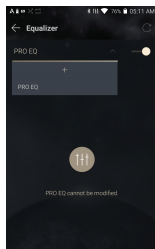

3. Enter a name for the custom EQ settings and select [Save].

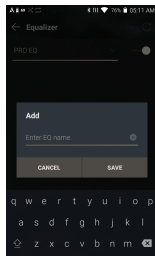

- Adjust the frequencies up and down according to preference.
- The number values at the lower-left corner of the screen can be adjusted for fine-tuning.



- Press the [Advanced] tab on the top of the screen to view the PEQ setting screen. Adjust Freq/Gain/Q.



Deleting a Custom Equalizer Setting

1. Press [Pro EQ] at the upper-left corner of the screen.
2. Press [🗑️] next to the EQ name to delete the selected EQ setting.

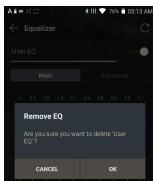
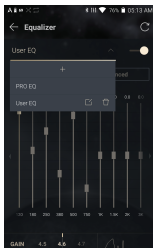

Renaming an Equalizer Setting

1. Press [Pro EQ] at the upper-left corner of the screen.
2. Press [📄] next to the EQ setting name you wish to change and enter a new name for the selected EQ.
3. Press [Rename] to save the changes.

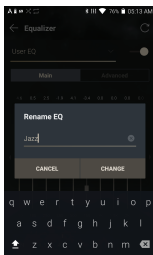

Safety Pre- cautions

Device

- Do not use excessive force when inserting a plug into the earphones, balanced, or USB port.
- Do not insert any metal objects (coins, hairpins, etc.) or flammable items into the device.
- Do not place heavy objects on the device.
- If the device gets wet (rain, water, chemicals, medicine, cosmetics, sweat, moisture, etc.), allow the device to dry thoroughly before powering on. Contact the nearest Iriver Customer Support Center for service. (Damage due to liquid exposure will be repaired for an additional fee even if the device is under warranty. Damage may not be repairable.)
- Avoid exposing the device to direct sunlight or extreme temperatures (-10°C - +50°C; 14°F~ 122°F) such as the inside of a car during the summer.
- Do not store or use in hot and humid places such as saunas.
- Avoid use in places with excess moisture, dust, or smoke.
- Do not use for extended periods on blankets, electric blankets, or carpet.
- Do not place near a fire or in a microwave.
- Never attempt to disassemble, repair, or alter the product.
- Do not store for extended periods of time in a confined space with the power on.
- Do not place the device near magnetic objects (magnets, televisions, monitors, speakers, etc.).
- Never use chemicals or cleaning products on the device since they can damage the surface coating and finish.
- Avoid dropping or subjecting the device to a strong impact (excessive vibration, etc.).
- Do not press multiple buttons simultaneously.
- Do not disconnect the USB Type-C cable during data transfer.
- When connecting the USB Type C cable, use the USB port on the back of the PC. Connecting to a defective or damaged USB port may damage the device.

- Connecting to a defective or damaged USB port may damage the device.
- Displaying one static image for an extended period of time may cause screen burn-in.
- Use of poor quality protective films or adhesive stickers on the screen may cause damage to the touchscreen.
- Do not insert any foreign objects into the headphone port.
- Playing and charging the device may generate heat, so handle carefully.
- Product's corners may be sharp, so handle carefully.

Other

- Do not use earphones/headphones or operate the device while operating any type of vehicle. It is not only dangerous, but may be against the law in certain regions.
- Do not use the product during physical activities (driving, walking, hiking, etc.).
- Be aware of your environment to avoid the risk of accidents.
- Pay attention to your surroundings when using the device while walking or moving.
- Avoid using the device during thunderstorms to reduce the possibility of electric shock.
- If there is a ringing in your ears during or immediately after use, lower the volume or discontinue use of the device and seek medical advice.
- Do not listen to music at excessive volumes for extended periods.
- Do not use earphones/headphones at excessive volumes.
- Be careful not to get the earphones/headphones caught in other objects.
- Do not sleep with earphones in your ears or leave them in for extended periods.

Trouble-shooting

Solutions to common problems

1. The device won't turn on.
 - The battery may need to be recharged. Charge the device for at least one hour and try again.
 - Reset the device. (See Page 5)
2. The device will not charge when connected to a computer via USB cable.
 - Connect to the computer using a USB Type-C cable.
 - Connecting to the computer with a micro USB cable will not charge the product.
 - Connect to a charging adapter using a USB Type-C cable.
3. The computer won't recognize the device or an error message appears when connected.
 - Use a USB port on the back of the computer.
 - Check that the USB Type-C cable is properly connected.
 - For Windows XP, verify that Service Pack 2 (or higher) and Windows Media Player 10 (or higher) are installed.
 - Check if the device connects properly on a different computer.
4. The screen turns off repeatedly.
 - The screen turns off automatically after a set time to reduce battery consumption. Change the time setting in [Menu- Settings - Power Saving - Screen Timeout].
5. The screen does not display images properly.
 - Check the screen for debris.
6. There is no sound, or there is static/interference.
 - Check that the volume setting is above [0].
 - Check that the earphones are plugged in properly, and make sure nothing is obstructing the port connection.
 - Verify that the music file is not corrupt.
 - Verify that the audio settings have been set properly. (Balanced out, line out, etc.)

7. A file does not play, or the product becomes unstable when a certain file is played.
 - File may be damaged or corrupt if the following occurs:
 - Playback stops or freezes.
 - Device may act erratically or freeze.
 - File may sound different on another device.
 - There may be a difference in the performance of playback or other functions.
 - There may be differences in the file specs.
 - Converting the file to a different format or use of a different file is recommended.

Copyright

iriver Limited retains the rights to patents, trademarks, copyrights, and other intellectual property rights related to this manual. No contents of this user manual may be duplicated or reproduced in any format or by any means without the prior approval of iriver.

Using or reproducing, in whole or part, the contents of this document is subject to penalties. Software, audio, video, and any other copyrighted contents are protected in accordance with relevant copyright laws.

The user accepts all legal responsibility for the unauthorized reproduction or distribution of the copyrighted contents from this product.

Companies, organizations, products, people, and events used in the examples are not based on actual data. iriver has no intention to be associated with any company, institution, product, person, or incident through this instruction manual, and no such inference should be made. It is the responsibility of the user to comply with applicable copyright laws.

©1999~2017 iriver Limited. All rights reserved.

The PPR11 was designed and audio-tuned under the advisement of MSD.

Certifications

KC / FCC / CE / TELEC

Class B Device (Communication equipment for residential use): This is a Class B Device and is registered for EMC requirements for residential use. This device can be used in residential areas and all other areas.



FCCID: QDMPPR11

This device complies with Part 15 of the FCC Rules, Operation is subject to the following two conditions: (1) this device may not cause harmful interference, and (2) this device must accept any interference received, including interference that may cause undesired operation.

FCC Caution Any changes or modifications not expressly approved by the party responsible for compliance could void the user's authority to operate this equipment.

(b) For a Class B digital device or peripheral, the instructions furnished the user shall include the following or similar statement, placed in a prominent location in the text of the manual: NOTE: This equipment has been tested and found to comply with the limits for a Class B digital device, pursuant to part 15 of the FCC Rules. These limits are designed to provide reasonable protection against harmful interference in a residential installation.

This equipment generates, uses and can radiate radio frequency energy and, if not installed and used in accordance with the instructions, may cause harmful interference to radio communications. However, there is no guarantee that interference will not occur in a particular installation. If this equipment does cause harmful interference to radio or television reception, which can be determined by turning the equipment off and on, the user is encouraged to try to correct the interference by one or more of the following measures:

- Reorient or relocate the receiving antenna.
- Increase the separation between the equipment and receiver.
- Connect the equipment into an outlet on a circuit different from that to which the receiver is connected.
- Consult the dealer or an experienced radio/TV technician for help

Body-Worn operation

This device was tested for typical body-worn operations with the back of the portable music player kept 5mm. from the body. To maintain compliance requirements, use only belt-clips, holsters or similar accessories that maintain a 5mm separation distance between the user's Body and the back of the Portable music player, including the antenna. The use of belt-clips, holsters and similar accessories should not contain metallic components in its assembly. The use of accessories that do not satisfy these requirements may not comply with CE RF exposure requirements, and should be avoided.

Body-worn accessory exposure conditions "Specific information must be included in the operating manuals to enable users to select body-worn accessories that meet the minimum test separation distance requirements. Users must be fully informed of the operating requirements and restrictions, to the extent that the typical user can easily understand the information, to acquire the required body-worn accessories to maintain compliance. Instructions on how to place and orient a device in body-worn accessories, in accordance with the test results, should also be included in the user instructions. All supported bodyworn accessory operating configurations must be clearly disclosed to users through conspicuous instructions in the user guide and user manual to ensure unsupported operations are avoided. All body-worn accessories containing metallic components must be tested for compliance and clearly identified in the operating manual. The instruction must inform users to avoid using other body-worn accessories containing metallic components to ensure RF exposure compliance."

Registered Trademarks

Windows 2000, Windows XP, Windows 7, Windows 8, Windows 10, and Windows Media Player are registered trademarks of Microsoft corp.



Disclaimers

The manufacturer, importer, and distributor shall not be liable for damages including accidental and personal injury due to the improper use or operation of this product. The information in this user manual was written based on current product specifications. The manufacturer, iriver Limited, is adding new complementary features and will continue to apply new technologies in the future. All specifications may be changed without prior notice. There is no warranty against data loss due to the use of this product.

The device must be used a minimum of 5mm away from the body in normal use conditions.

Specifications

General Specifications	
Model	PPR11
Body Material	Aluminum
Display	5.0inch HD 720 x 1280 touch screen
Supported Audio Formats	WAV, FLAC, WMA, MP3, OGG, APE, AAC, ALAC, AIFF, DFF, DSF
Sample rate	PCM : 8kHz ~ 384kHz (8/16/24/32bits per Sample) DSD Native: DSD64(1bit 2.8MHz), Stereo / DSD128(1bit 5.6MHz), Stereo / DSD256(1bit 11.2MHz), Stereo
Output Level	Unbalance 2.0Vrms / Balance 4.1Vrms [Condition No Load]
DAC	ESS9038PRO x1 (8-channel DAC)
Decoding	Support up to 32bit / 384kHz Bit to Bit playback
Input	USB Type-C input (for charging & PC & MAC)
Outputs	PHONES (3.5mm) / Optical Out (3.5mm) / Balanced Out (2.5mm, only 4-pole supported)
Wi-Fi	802.11 b/g/n (2.4GHz)
Bluetooth	V4.1 (A2DP, AVRCP, aptX™ HD)
Dimensions	2.98" (75.85mm)[W] x 5.22" (132.7mm)[H] x 0.60" (15.3mm)[D]
Weight	8.5oz (241g)
Feature Enhancements	Firmware upgrade supported(OTA)
Operating Temperature	-10°C ~ + 50°C (14°F ~ 122°F)
Audio Specifications	
Frequency Response	±0.09dB (Condition : 20Hz~20kHz) Unbalance / ±0.08dB (Condition : 20Hz~20kHz) Balance,
S/N	122dB @ 1kHz, Unbalance / 123dB @ 1kHz, Balance
Crosstalk	137dB @ 1kHz, Unbalance / 144dB @ 1kHz, Balance
Storage Capacity	
Built-in Memory	128GB[NAND]
External Memory	microSD[Max. 256GB] x 1
Battery	
Capacity	3,700mAh 3.8V Li-Polymer Battery
Supported OS	
Supported OS	Windows XP, Windows 7,8,10(32/64bit) MAC OS X 10.7.