

Declaration of Conformity

Supplier name: One2touch AS
Supplier address: Tollbugaten 24, 0157 Oslo, Norway
Declares that the product name and model: Softpad S1
Product operation: all

Confirms to the following product specifications and regulation:

EMC standard: EN 301489-3/1

Radio standard: NFC 13,56MHz: EN 302291

Safety standard: EN 60950-1

The product herewith complies with the requirements of the Low Voltage Directive 2006/95/EC, the EMC directive 2004/108/EC, the R&TTE directive 1999/5/EC, and carries the CE-marking accordingly.

This device complies with Part 15 of the FCC Rules. Operation is subject to the following two conditions: (1) This device may not cause harmful interference, and (2) this device must accept any interference received, including interference that may cause undesired operation.

DoC can be downloaded from www.one2touch.no

Battery warning!

Risk of explosion or personal injury if batteries are replaced with incorrect type, mutilated, or exposed to conducting material, liquid, fire or heat (above 56 degree Celsius). Do not use or recharge damaged rechargeable batteries. Do not mix battery types. Dispose of spent or damaged batteries according to manufacturer instructions and local laws.

Changes or modifications to the equipment not expressly approved by the party responsible for compliance could void the user's authority to operate the equipment.

NOTE: This equipment has been tested and found to comply with the limits for a Class B digital device, pursuant to Part 15 of the FCC Rules. These limits are designed to provide reasonable protection against harmful interference in a residential installation. This equipment generates, uses and can radiate radio frequency energy and, if not installed and used in accordance with the instructions, may cause harmful interference to radio communications. However, there is no guarantee that interference will not occur in a particular installation.

If this equipment does cause harmful interference to radio or television reception, which can be determined by turning the equipment off and on, the user is encouraged to try to correct the interference by one or more of the following measures:

- Reorient or relocate the receiving antenna.
- Increase the separation between the equipment and receiver.
- Connect the equipment into an outlet on a circuit different from that to which the receiver is connected.
- Consult the dealer or an experienced radio/TV technician for help.

Environmental information (Applicable in the European countries with separate collection systems).



Disposal of waste batteries. This product may contain batteries. If so, this symbol on the batteries means that they shall not be disposed with other household waste. Instead they shall be handed over to the appropriate collection point for the recycling of batteries. The batteries do not contain Mercury, Cadmium or Lead above the levels defined by the battery directive 2006/66/EC. For your safety, please view the product manual how to remove the batteries from the product safely.



Disposal of old electrical & electronic equipment. This symbol indicates that this product shall not be treated as household waste. Instead it shall be handed over to the appropriate collection point for the recycling of electrical and electronic equipment. The recycling of materials will help to conserve natural resources.

By ensuring this product and its batteries are disposed of correctly, you will prevent potential negative consequences for the environment and human health, which otherwise be caused by inappropriate waste handling of them. For more detailed information about the recycling of these batteries or this product, please contact your local city office, your household waste disposal service or the shop where you purchased the product.

The product and packaging will bear the following marks:



User guide

Smartphone setup

1

Enable NFC in your smartphone settings

2

Place your phone on the NFC tag, or search for "one2touch" on Google Play, to download the one2touch driver.

3

Place your phone on the NFC keyboard and follow the on-screen instructions* to enable the one2touch keyboard

*For step by step picture setup, visit www.one2touch.no

FOLDING:

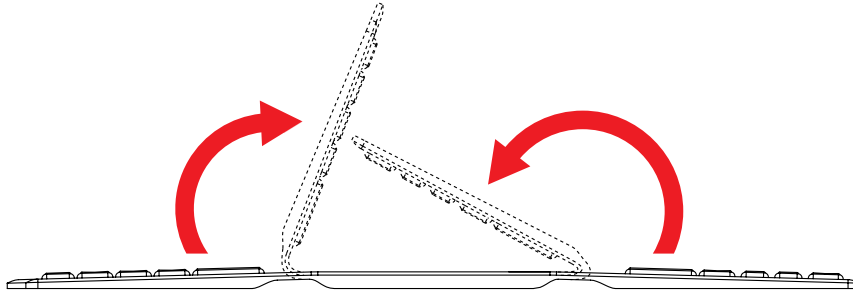

STRAP:

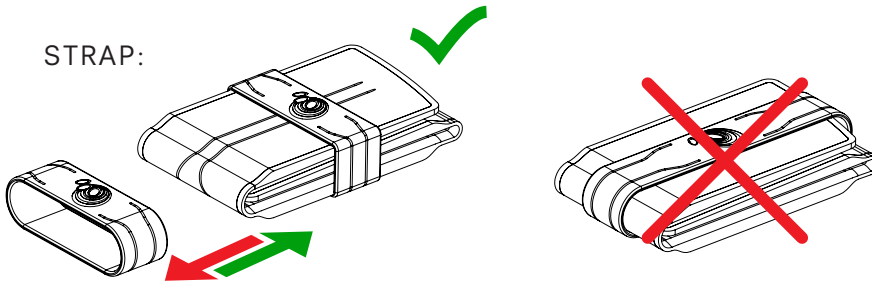

DO NOT TWIST:

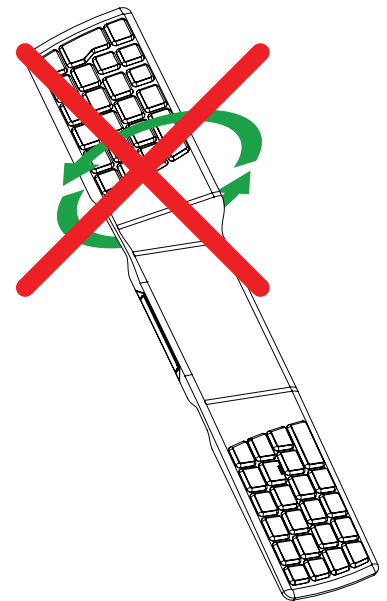

STEP-BY-STEP

1. Pull out the battery drawer
2. Remove old batteries
3. Insert new CR2025 batteries
4. Re-insert battery drawer

- Old batteries
- Replacement batteries
- ① Only use (Lijia) CR2025 batteries

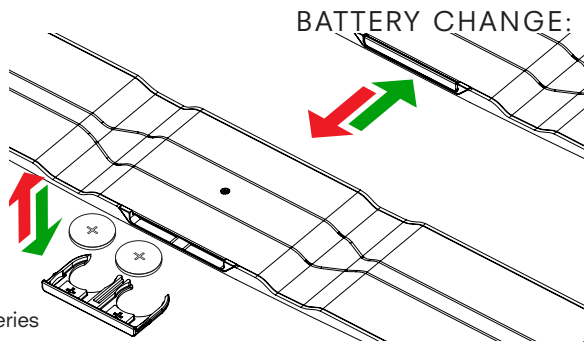

BATTERY CHANGE:

Troubleshooting

Nothing happens when placing the phone on the keyboard

Does the phone have power?	Connect your phone to a charger
Are there batteries in the NFC Keyboard?	Open the battery drawer and make sure the batteries are inserted
Does the phone support NFC?	Check the documentation for your phone
Is NFC enabled in your phone?	Check your wireless settings to enable NFC. (check phone documentation for instructions)
Is the phone within the antenna area?	Make sure the phone has sound on and the keylock is off, then move the phone around on the keyboard until you hear a beep.

The phone connects to the keyboard (audible beep), but nothing happens when I press the keys.

Have you installed the one2touch driver?	Use the NFC tag that came with the keyboard, or search for "one2touch" on Google Play to install the driver.
	Follow the on-screen instructions for first time setup when connecting the phone to the keyboard.