

1 ACCESSORIES LIST

- User Manual
- Quick Setup Guide
- Remote Control
- Screws (M3 x 1.5mm) x10
- Screws (2.5 x 1.5mm) x12
- Wall-mounting screw (M3 x 45mm) x4
- Batteries AAA x 2
- Spacer x 4

2 INSTALLING THE STAND

Follow the illustrations below to complete the installation steps.

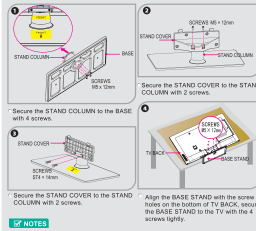

Notes: Please refer to the user manual for more information. Adjust product settings in advance. Carefully place your TV. Be careful not to scratch the screen or damage the TV. Do not touch the screen.

3 INSTALLING A WALL-MOUNT BRACKET

If you want to attach the TV to a wall-mount bracket (not provided), you should first remove the stand if it is pre-attached.

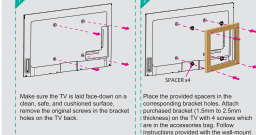

Notes: These 4 screws will get from back cover once back cover is removed.

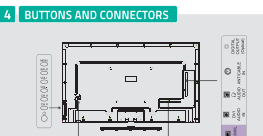
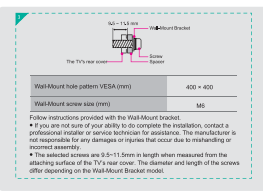

Item	Description
REMOTE	Display the on-screen menu to setup your TV's features.
INPUT	Select the different input signal sources.
VOLUME / CH / TV	Adjust the volume. Select the channel.
(Power button)	Turn on the TV or put the TV in standby mode. Caution: The TV continues to consume power even in standby mode. Unplug the power cord to disconnect power.
ANTICABLE	Connect an antenna or cable TV to this jack.
HDMI	HDMI (High-Definition Multimedia Interface) provides an uncompressed, all-digital audio/video interface between the TV and any HDMI device, such as a set-top box, Blu-ray disc player, or AV receiver. All HDMI inputs can support HDCP when using HDCP-compatible cables. The DVI audio should be connected to DVI AUDIO IN.
COMPONENT IN	Connect to a DVD player, Digital Set-Top-Box, or other AVY devices with component (YPbPr) video and audio output jacks.
AV IN	Connect to the composite video and audio (L/R) output jacks on external video devices.
DVI AUDIO IN	Connect to a PC or other devices with a 3.5mm TRS jack.
AUDIO OUT	Connect headphones or analog sound system using 3.5mm TRS jack. (TV speaker must be LG provided product).
DIGITAL OUTPUT	Connect an audio amplifier to this jack.
USB	Port for Digital Media Player and for software update.

5 REMOTE CONTROL

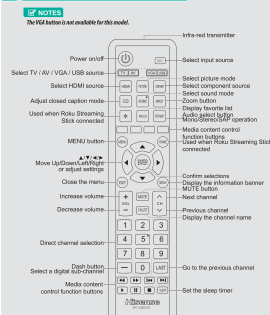

- CHANGE THE BATTERIES**
- Slide the back cover to open the battery compartment of the remote control.
 - Insert two AAA size batteries. Make sure to match the (+) and (-) ends of the batteries with the (+) and (-) ends indicated in the battery compartment.
 - Close the battery compartment cover.



6 TV CONNECTORS

Check the jacks for position and type before making any connections. Loose connections can result in image or color problems. Make sure that all connections are tight and secure.

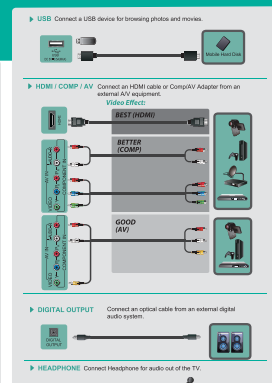
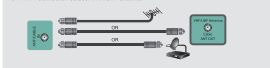

7 SPECIFICATIONS

Model Name	55K20D
Dimension	Without Stand: Width: 48.09 inches (1246.9 mm), Height: 29.13 inches (740 mm), Depth: 3.11 inches (79.5 mm) With Stand: Width: 49.09 inches (1246.9 mm), Height: 31.29 inches (794.6 mm), Depth: 3.11 inches (79.5 mm)
Weight	Without Stand: 41.8 lbs (19.0 kg) With Stand: 52.7 lbs (24.0 kg)
LCD Panel Minimum size (Diagonal)	55 inches
Screen resolution	1920 x 1080
Audio power	2 x 8 W x 100
Power supply	120 V ~ 60 Hz
Receiving / Emitting System	Digital
Receiving channels	ATSC/CMM (HF, VHF, UHF), ISDB-T, ISDB-Tsb, DVB-T, DVB-T2, Digital Terrestrial Broadcast (DTMB), DVB-S, DVB-S2, Digital Cable (QAM/CS), IS-132
Tuner type	Frequency synthesized
Environmental conditions	Temperature: 0 °C ~ 35 °C (32 °F ~ 95 °F) Humidity: 20% ~ 80% RH Digital cable (QAM/CS): IS-132
Component input	480i/1080i, 480p/1080p, 720p/1080p, 1080i/1080p, 1080p/1080p
HDMI input	1080p/1080i, 480p/1080p, 720p/1080p, 1080i/1080p, 1080p/1080p

8 TURNING THE TV ON FOR THE FIRST TIME



Note: If you are using a cable or satellite box and have connected the TV to a digital cable, you need select the cable system. Be sure the cable or satellite box is turned on before turning the power on. You can also unplug the connected A/V equipment or HDMI, use don't need to use for channel.

9 HELP TOPICS

When there is something wrong with your TV, you can try turning off the TV and restarting it. You can also refer to the following chart for problem and solution tips.

SYMPTOMS	POSSIBLE SOLUTIONS
No sound or picture	<ul style="list-style-type: none"> Confirm power cord is plugged into the AC outlet and the AC outlet is getting electricity. Attempt to power on using the power button on both the TV and the Remote.
Picture is normal, but no sound	<ul style="list-style-type: none"> Check the volume settings. Check if Mute mode is set "on".
I have connected an external source to my TV and picture is blurry or out of focus	<ul style="list-style-type: none"> Check for the correct output connection on the external source and for the correct input connection on the TV. Make sure you have made the correct selection for the external source for the incoming signal.
Sound and picture distorted or appear wavy	<ul style="list-style-type: none"> Press and hold picture first using TV set. Turn off any appliances. Check Color Setting Function is lock and unlock.
Sound and picture is blurry or out of focus	<ul style="list-style-type: none"> An electrical appliance may be affecting TV set. Turn off any appliances. If interference goes away, remote appears normal again. Reset the external of the TV set into another power outlet.
TV can't find what I set the Channel to Cable? They work with the Air setting?	<ul style="list-style-type: none"> If using an external antenna, check the direction, position and connection of the antenna. Adjust the direction of your antenna or reset or fine tune the channel.
Remote control does not work.	<ul style="list-style-type: none"> Confirm the TV still has power and is operational. Change the batteries in the remote control. Check if the batteries are correctly installed. Check the front of the remote control (LED window). If using an external remote, be sure to select the TV mode on the remote. If the remote still does not work: Remove and reinsert the batteries correctly to reset the remote or install new batteries. Press the Power button to turn on the TV. With a universal remote you may need or changed the batteries you will need to reprogram the remote for the other user. Check if there is obstruction between the remote control and the TV. If you have a digital camera's camera phone, you can aim the front of the remote at camera lenses (not the lens, the camera should set on camera mode, not play mode). Observe the camera screen while pressing a button on the remote control; you should see flashing light on the screen. If there is no light observed, the remote control is not working. You need to replace or repair the remote control.